

## TOWN OF DUNDURN BYLAW 2014-11

A bylaw to amend Bylaw No. 11-87 known as the Town of Dundurn Zoning Bylaw.

The Council of the Town of Dundurn, in the Province of Saskatchewan, enacts to amend Bylaw 11-87 as follows:

**1. Insert Section 2.85 Shipping Container** - shall mean a prefabricated metal container or box specifically constructed for the transport and storage of goods by rail, ship or transport truck that is of any size.

**2. Insert Section 2.90 Trailer, Semi** - shall mean a trailer having wheels only in the rear; the front is supported by a towing vehicle. For the purpose of this bylaw a Semi-trailer, with all running gear removed used for the transport and storage of goods that is of any size.

**3. Insert Section 3.2.2.7 - Shipping Containers and Trailers-Semi**

**4. Insert Section 4.15 Shipping Container & Semi-trailer restrictions** as follows:

**Shipping containers and Semi-trailers are accessory structures and shall be classified as :**

Temporary (short term) Storage – containers & trailers placed on site for a specified and limited period of time (less than 3 months) and used for short term storage typically associated with construction activities which are being undertaken on a site (ie: storage of tools, construction materials). Containers are to be removed from the site when construction is complete or after three (3) months, whichever comes first. If an extension is required, a written request must be made to the Development Officer. Shipping Containers are allowed for short term storage up to three (3) months in all zoning districts on approval from the Development Officer. The application for a temporary shipping container or semi-trailer shall be made to the Development Officer in Form E attached to and forming part of this bylaw. The application shall be accompanied by a copy of a lot and building plan showing dimensions and location of existing and proposed structure as well as lot lines.

The following regulations shall apply:

- 4.15.1 Shipping containers & Semi-trailers to be placed in the Town for short term storage require completion of Form "E" Temporary Storage Container Application accompanied by a copy of the lot and building plan showing dimensions and location of existing and proposed structure as well as lot lines.
- 4.15.2 Shipping containers & Semi-trailers are prohibited for placement in any Zoning District except for in the case where the container is approved for temporary storage.
- 4.15.3 Shipping containers & Semi-trailers may only be used for storage of product directly related to the primary use of the building on the site.



Zoning Bylaw 2014-11

- 4.15.4 Shipping containers & Semi-trailers may not be leased, rented or used by an outside party other than the property owner or business tenant located on the site without permission from Council.
- 4.15.5 Shipping containers & Semi-trailers are prohibited for the storage of junk, trash, or other forms of refuse or hazardous substances or perishable items.
- 4.15.6 Shipping containers & Semi-trailers shall be kept locked to prevent unauthorized access.
- 4.15.7 Shipping containers & Semi-trailers shall be strictly prohibited for use as human habitation.
- 4.15.8 Shipping containers & Semi-trailers total area shall not exceed 20% of the principle building's gross floor area, and in no case shall any site be permitted more than three (3) containers without prior consent from Council. No individual container shall exceed 39.39 square meters (424 square feet) or 2.44 meters (8 feet) in height, 2.44 meters (8 feet) in width, and 16.16 meters (53 feet) in length.
- 4.15.9 Shipping containers shall not be stacked on top of one another and shall be spaced apart a minimum of 3.0 meters.
- 4.15.10 Shipping containers & Semi-trailers shall be placed on a hard packed level surface and any bottom drainage holes shall be secured against the environment and/or rodents.
- 4.15.11 Shipping containers & Semi-trailers are prohibited from being plumbed or electrified in any manner.
- 4.15.12 All shipping containers & Semi-trailers will be placed in the rear yard for when possible. Where the Town determines that the proposed location of the shipping container on a site will cause land use compatibility issues with adjacent property, the Town may require the proponent to adequately screen the container from the view of adjacent properties by the use of fencing (or other suitable structure) or soft landscaping.
- 4.15.13 Shipping containers & Semi-trailers shall not block, obstruct, or reduce exits, windows, parking spaces, driveways or access to emergency services or equipment.

Read a first time this 10<sup>th</sup> day of November, 2014.  
Read a second time this 24<sup>th</sup> day of November, 2014.  
Read a third and final time this 24<sup>th</sup> day of November, 2014.

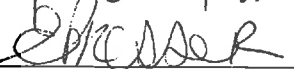

  
\_\_\_\_\_  
Doug Narraway, Mayor

  
\_\_\_\_\_  
Eileen Prosser, Administrator

**Town of Dundurn**  
**Form E to Bylaw 11-87 - Application for Approval**  
**Temporary Shipping Container, Bylaw 2014-11**

Permit # \_\_\_\_\_

Date of Application: \_\_\_\_\_ Date Received: \_\_\_\_\_

Name of Applicant: \_\_\_\_\_ Owner of Property: YES NO

Mailing Address: \_\_\_\_\_

Contact Information: (home) \_\_\_\_\_ (cell) \_\_\_\_\_

Email Address: \_\_\_\_\_

Container Size: \_\_\_\_\_

Proposed Location: (Note: container must be placed in backyard when possible)

\_\_\_\_\_  
\_\_\_\_\_

Proposed Usage: \_\_\_\_\_

\_\_\_\_\_  
Date of Delivery: \_\_\_\_\_

Date of Removal (maximum 3 months): \_\_\_\_\_

**Approval has been granted** for the installation of a temporary shipping container as per the information stated above, with the following conditions:

\_\_\_\_\_  
\_\_\_\_\_

**Approval has NOT been granted** for the installation of a temporary shipping container because:

\_\_\_\_\_  
\_\_\_\_\_

\_\_\_\_\_  
Development Officer, Town of Dundurn

\_\_\_\_\_  
Date

**Form E to Bylaw 11-87 (continued)**

Civic Address: \_\_\_\_\_

Legal Address: \_\_\_\_\_

Zoning Designation: \_\_\_\_\_

Lot Plan – show lot location, existing buildings and proposed container placement:

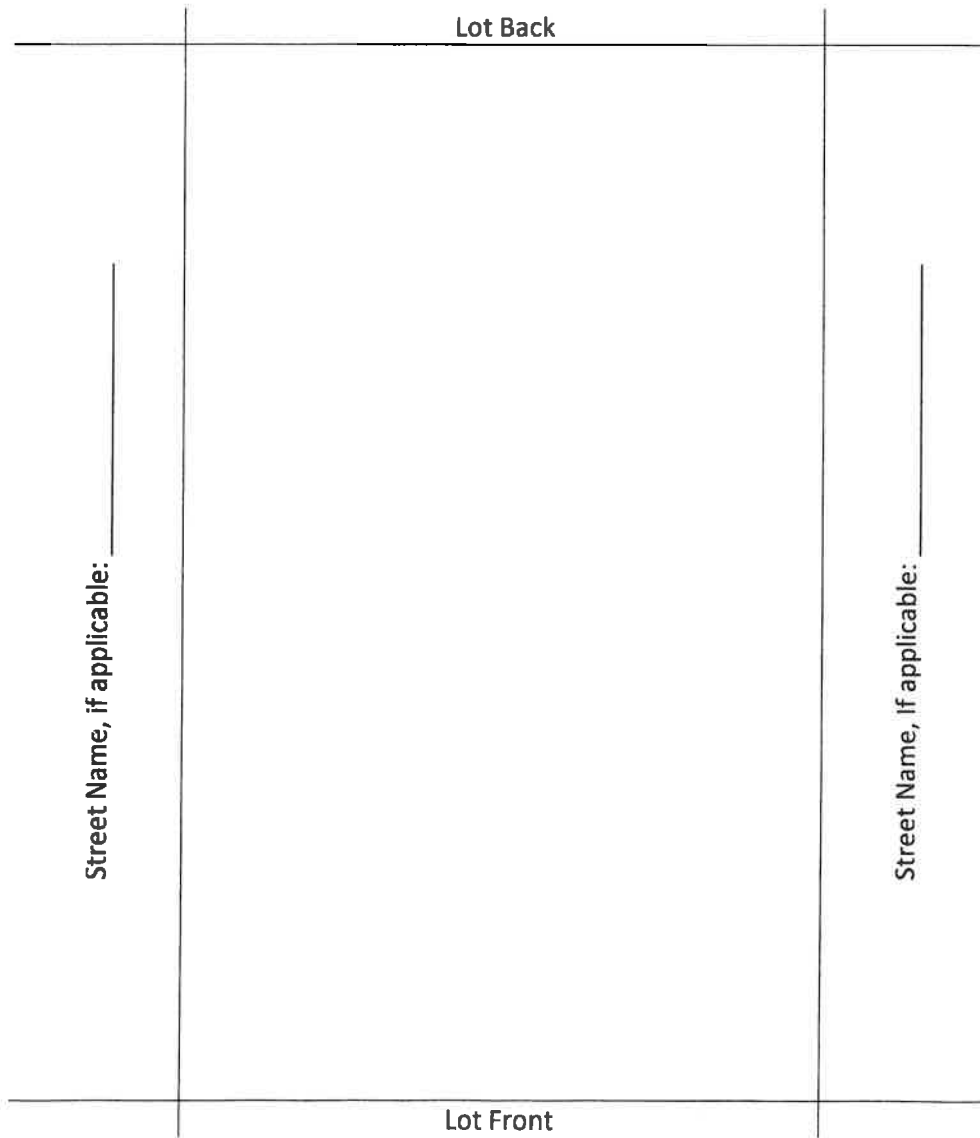

Street Name: \_\_\_\_\_